



BX1712 1997 GMC K3500 Installation Instructions

Attachment Tab Height: 16"

Attachment Tab Width: 24"

Serial Number

Please read BOTH these Installation Instructions and the General Instructions prior to installing or operating this equipment.

- Blue Ox® towing products and accessories are intended to be installed by Blue Ox® Dealers who are familiar with our products and have the equipment and knowledge necessary to do "fit work". If needed, Blue Ox® Dealers can be found at www.blueox.com or by contacting our Customer Care Department at (402) 385-3051.
- Many Blue Ox® baseplates are designed to use existing holes and hardware to mount the baseplate to the towed vehicle. Even though bolts are there, do not assume they are adequate for baseplate mounting. Always use the hardware supplied in the hardware kit and existing hardware as specified in the installation instructions.



If the front of your vehicle looks different than this, please contact us at (402)385-3051.

Reference your vehicle owner's manual for manufacturer's towing specifications.

Bolt Torque Specifications

Torque in Foot-Pounds for Inch Bolts

| Bolt Size | Grade 5 | Grade 8 |
|-----------|---------|---------|
| 1/4" | 10 | 14 |
| 5/16" | 19 | 29 |
| 3/8" | 33 | 47 |
| 7/16" | 54 | 78 |
| 1/2" | 78 | 119 |
| 5/8" | 154 | 230 |
| 3/4" | 257 | 380 |

Bolt Torque Specifications

Torque in Foot-Pounds for Metric Bolts

| Bolt Size | Grade 8.8 | Grade 10.9 |
|-----------|-----------|------------|
| 6MM | 6 | 8 |
| 8MM | 16 | 22 |
| 10MM | 31 | 40 |
| 12MM | 54 | 70 |
| 14MM | 89 | 117 |
| 16MM | 161 | 230 |
| 18MM | 222 | 318 |



WARNING

Failure to read and follow these instructions could result in separation of the towed vehicle from the tow bar, causing property damage, loss of towed vehicle, personal injury or death.

BX1712
1997 GMC K3500
Installation Instructions

Instruction Notes: The tow hooks are removed and not reinstalled for the baseplate installation. Some drilling and trimming is required.

Place all components that are removed on a flat, sturdy surface. All items will be reinstalled unless otherwise noted after the baseplate is installed.

The dimensional variations between otherwise identical vehicles can be considerable. While the baseplate was designed for easy installation, it may be necessary to tailor the baseplate slightly to compensate for vehicle manufacturer's tolerances.

The BX8869 Tail Light Wiring Kit is recommended for this vehicle.

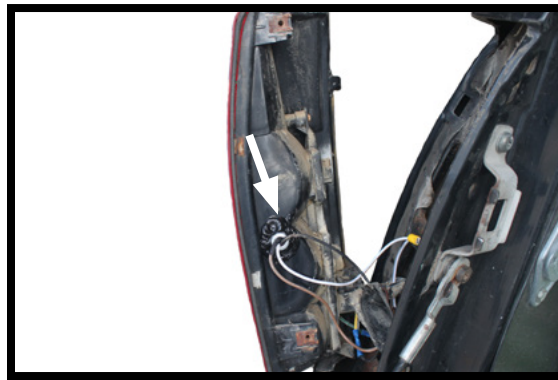

Drill a hole according to the tail
light wiring kit instructions.

NOTICE

- Handling of some cosmetic parts when installing this product may require the use of protective covers, rags, specialty tools, etc. to prevent damage.
- When using power drills be aware of the dangers of torque and drill bit length.
- When using a reciprocating saw be aware of objects behind the cutting surface.
- Use a good quality paint to spray cut edges of frame to prevent rusting.
- Be sure that **ALL** electrical connections are plugged in and accessories are functioning properly before reinstalling the fascia.
- The baseplate is computer tested to your vehicle's GVWR, exceeding this weight will void the manufacturer's warranty.
- Be sure to use Loctite® Red on all bolts before tightening. Tighten all bolts according to the torque chart provided.
- Dealer or installer be certain the user receives these instruction sheet.
- If the baseplate is in an accident, it must be replaced. **DO NOT** use it again! An accident can cause unseen damage and using it again could result in more damage or serious injury. **DO NOT** use the baseplate if it is damaged or missing parts.

BX1712 1997 GMC K3500 Installation Instructions

Tools Required

Large Vise Grip
Torque Wrench
Drill
Tape Measure
Loctite® RED
1/2" Drill Bit
18MM Socket
19MM Socket
21MM Socket
3/4" Socket
3/4" Wrench

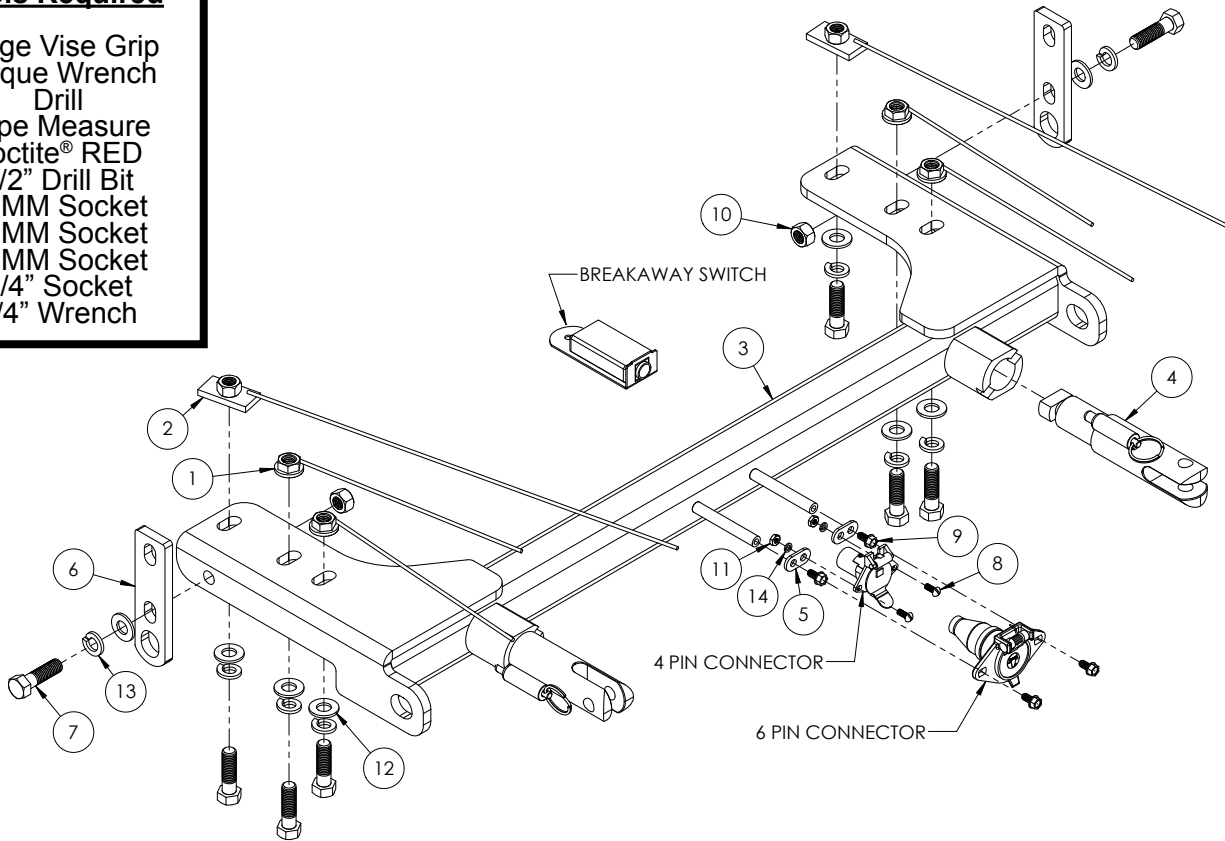

| Item No. | Part No. | Description | Qty. |
|----------|--------------------------|---|------|
| 1..... | 61-4029..... | 1/2"-13 Whiz Nut w/ 10" Wire | 4 |
| 2..... | 61-5496..... | 1/2"-13 Nut Plate w/ 14" Wire | 2 |
| 3..... | 61-7262..... | BX1712 Baseplate..... | 1 |
| 4..... | 62-3468..... | Attachment Tab Assembly with Hole | 2 |
| 5..... | 101-5822..... | 4 Way Connector Adapter | 2 |
| 6..... | 102-5318..... | Safety Cable Bracket..... | 2 |
| 7..... | 201-0068..... | 1/2"-13 x 1-3/4" Hex Head Bolt, Grade 5, ZP | 8 |
| 8..... | 201-0192..... | #10-32 1/2" Round Slotted Head Screw..... | 2 |
| 9..... | 201-0553..... | 1/4"-20 x 1/2" Hex Wshd Bolt Type F TCS, ZP..... | 2 |
| 10..... | 202-0005..... | 1/2"-13 Hex Nut, ZP..... | 2 |
| 11..... | 202-0047..... | #10-32 Hex Nut | 2 |
| 12..... | 203-0005..... | 1/2" Flat Washer, ZP..... | 8 |
| 13..... | 203-0012..... | 1/2" Lock Washer, ZP | 8 |
| 14..... | 203-0054..... | #10 Lock Washer, ZP | 2 |
| 15..... | 226-0049(not shown)..... | Class IV Safety Cables..... | 2 |
| 16..... | 229-0512(not shown)..... | 1/2" Quicklink, ZP | 2 |
| 17..... | 290-0437(not shown)..... | Black Cap Plug Receiver..... | 2 |

Important:

Use only genuine factory replacement parts on your baseplate. Do **NOT** substitute homemade or non-typical parts. If a bolt is lost or in need of replacement, for your safety and the preservation of your baseplate, be sure to use a replacement bolt of the same grade (In most cases it will be Grade 5, please reference the parts list above). Replacement parts may be ordered through your nearest Blue Ox® Dealer or Distributor. Failing to follow and/or altering these installation instructions in either installation or required equipment will void the manufacturer's warranty. Towing behind a non-motorized vehicle will void the warranty.

BX1712
1997 GMC K3500
Installation Instructions

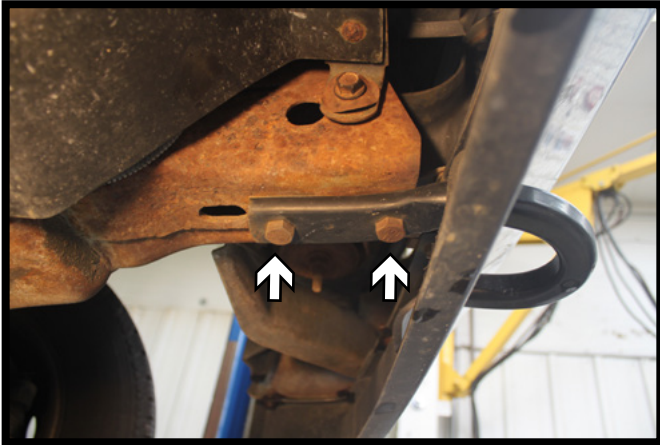

1. Using a 18MM socket, remove the four (4) bolts from the tow hooks. There are two (2) on each side.

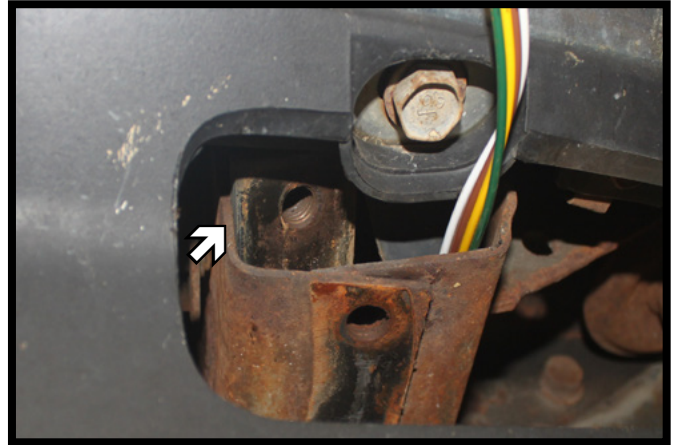

2. Remove the existing nut plates from the tow hook pockets.



3. Position the baseplate onto the frame, aligning to the holes in the frame and clamp in place. Install a 1/2"-13 x 1-3/4" bolt with 1/2" lock and flat washers into the front hole and a 1/2"-13 whiz nut on the inside of the frame. Do this on both sides of the vehicle. Fully tighten all hardware.

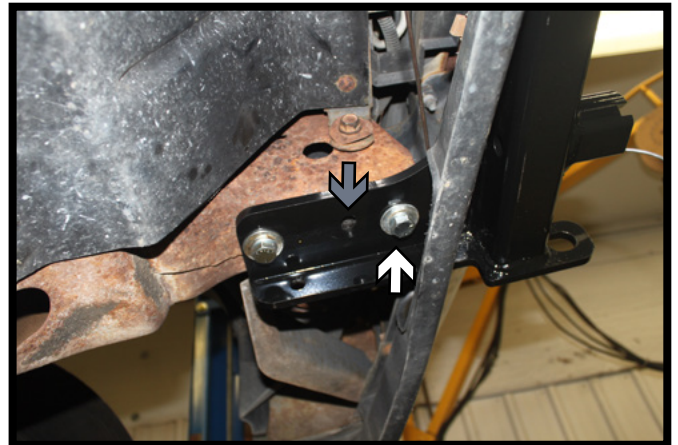

4. Install a 1/2"-13 x 1-3/4" bolt with 1/2" lock and flat washers into the front hole and a 1/2"-13 whiz nut on the inside of the frame. Do this on both sides of the vehicle. Fully tighten all hardware.

Using a 1/2" drill bit, drill the middle hole of the baseplate thru the frame (gray). Install a 1/2"-13 x 1-3/4" bolt with 1/2" lock and flat washers into the front hole and a 1/2"-13 whiz nut on the inside of the frame. Do this on both sides of the vehicle. Fully tighten all hardware.

BX1712
1997 GMC K3500
Installation Instructions

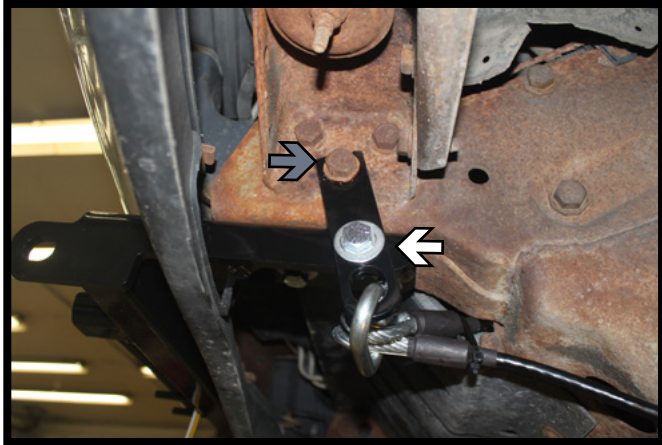

5. Using a 19MM socket, remove the existing bolt from the outside of the frame (gray). Install the safety cable bracket onto the frame, reusing the existing bolt and a 1/2"-13 x 1-3/4" bolt with 1/2" lock and flat washers (white) into the baseplate hole and a 1/2"-13 hex nut on the inside of the baseplate. Do this on both sides of the vehicle. Fully tighten all hardware.
6. Attach the permanent baseplate safety cables to the provided convenience link on the baseplate. The photo above shows the recommended installation of the cables to frame of vehicle. Additional options may interfere with suggested mounting; in this case, secure the cables to a solid piece of the frame as described in the instructions included with the permanent baseplate safety cables. Be sure the safety cables do not rub against any hoses or moving parts. Do this on **BOTH** sides of the vehicle.

CUSTOMER SERVICE COMMITMENT

Blue Ox® is committed to providing you with exceptional customer care throughout your lifetime with our products. Our team is here to assist you with any questions you may have regarding the performance of your product. Simply call (402) 385-3051 and you can speak with our customer care team.

Additionally, please visit our website to see which rallies our Destination America team will be attending. For a nominal fee, our service technician will service your towing system to ensure it's in proper working condition. Also, as a commitment to our customers, should you visit our factory, you can stay at our full service Blue Ox® campground at no charge along with enjoying a factory tour.

Again, thank you for being our customer and for the confidence you have shown in the performance of our products. It is because of customers like you we enjoy the success we have today.

© 2013 Blue Ox
One Mill Road, Industrial Park
Pender, Nebraska 68047
Phone: (402) 385-3051
Fax: (402) 385-3360
www.blueox.com